

COMMITTEE MEMO

To: Streets Committee, Jason Campbell, Committee Chair

From: Jamie Hall, Village Administrator

Date: October 4th, 2022

Re: Committee discussion for proposed safety improvements for the intersection of Buckeye and Main Street.

Committee, during my May 17th Council report I had mentioned that I would like to call for a committee meeting for discussion on improving the safety of the Buckeye and Main Street intersection by making East Buckeye one-way traffic heading east from Main to Johnson. Another benefit would be an increase of parking spaces in that area. I had informed Council that I would have Choice One Engineering do a safety evaluation of the intersection with comparison of the current traffic flow to a one-way traffic flow. I have attached the summary of that evaluation along with drawings showing conflict points (currently 32 that would be reduced to 20 with one-way traffic). The evaluation also showed a visibility concern as well as a drawing of angled parking on the north side of E Buckeye with an increase of 7 parking spaces.

Topics for discussion:

Does the intersection of Buckeye and Main need safety improvement?

Is the proposed one-way east traffic pattern from Main to Johnson a solution?

Should angle parking be considered if east Buckeye becomes one-way?

Should we include west Buckeye in the discussion of one-way traffic as well?

(Gilbert to Main, Main to Johnson all east bound one-way – COE says will reduce contact points even more)

Should we also add angle parking to west Buckeye if it becomes one-way?

(Would suggest no parking from 2am – 6:00 am for angle parking, parallel parking allowed overnight for downtown apartments)

Action would require signage and pavement marking

Would ask for motion, resolution, or ordinance if we proceed?

Safety research suggest that intersections crash rates are related to the number of conflict points at the intersection. **Conflict points** are locations in or on the approaches to an intersection where vehicles paths merge, diverge, or cross.

Thank you for your consideration, Jamie Hall

East Buckeye Avenue

9 messages

Matt Hoying <mjh@choiceoneengineering.com>
To: Jamie Hall <jhall@adaoh.org>

Mon, May 16, 2022 at 10:31 PM

Good evening Jamie,

Attached are some exhibits we pulled together to show the possibility of making East Buckeye Avenue a one way east bound street from Main Street to Johnson Street.

The first attachment "East Buckeye Concept-002" shows what the parking layout could be. The street is not wide enough to put angle parking on both sides, but we would recommend putting 45 degree angle parking on the north side and keeping the parallel parking on the south side.

The next three exhibits all relate to how making East Buckeye one way eastbound will make the intersection of Buckeye and Main safer.

- "East Buckeye Concept site plan – Conflict-Ex." – This shows how many points of conflict that could result in vehicle crashes there are with all four approaches being two way (32 conflict points)
- "East Buckeye Concept site plan – Conflict-Prop." – This shows how many points of conflict that could result in vehicle crashes there are with East Buckeye being one way east bound (20 conflict points). There are 12 less points of conflict by removing the westbound traffic which would suggest making that block one way would make the intersection safer.
- "East Buckeye Concept site plan – SightDistance" – Shows that for west bound traffic on East Buckeye, the appropriate site distance for a vehicle to know if it is safe to enter the intersection is NOT currently provided. The first three parking spaces in front of El Campo block the safe view of a driver stopped at the intersection going westbound.

In summary, we believe making East Buckeye Street a one way street eastbound between Main and Johnson will make the intersection safer, as it reduces the number of potential conflict points and removes the concern of sight obstruction for westbound traffic. A one-way eastbound East Buckeye street would also allow for an added benefit of more on-street parking than what currently exists in this block.

As always, if you have any questions, please let me know.

Thank you,

Matt Hoying, P.E.
President, **Choice One Engineering**
937.497.0200 Office | 937.726.9606 Cell

32 EXISTING CONFLICT POINTS

- "East Buckeye Concept site plan - Conflict-Ex." - This shows how many points of conflict that could result in vehicle crashes there are with all four approaches being two way (32 conflict points)

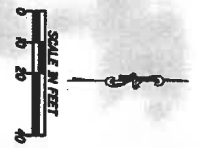
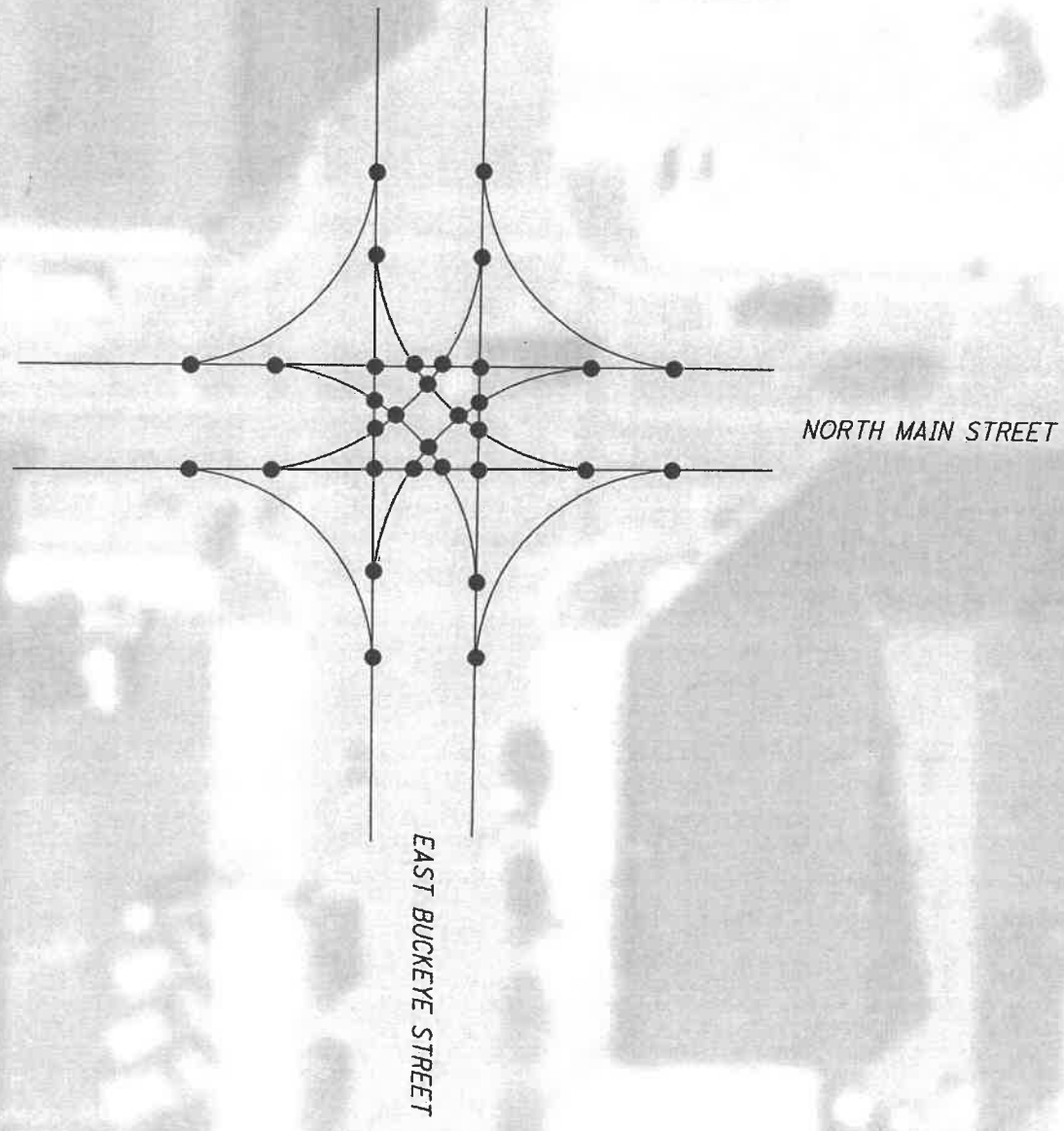

REVISIONS:
FILE NAME EXISTING
DRAWN BY MJC
CHECKED BY MJC
PROJECT No. 190101230
DATE 05/08/2022
SHEET NUMBER 1 OF 1

**EAST BUCKEYE STREET CONCEPT PLAN
VILLAGE OF ADA
CONFLICT POINTS - EXISTING**

SENEY, OHIO 937.477.0200
LOWELAND, OHIO 513.239.8354
WWW.CHOICEONEENGINEERING.COM



20 PROPOSED CONFLICT POINTS

- "East Buckeye Concept site plan - Conflict-Prop." - This shows how many points of conflict that could result in vehicle crashes there are with East Buckeye being one way east bound (20 conflict points). There are 12 less points of conflict by removing the westbound traffic which would suggest making that block one way would make the intersection safer.

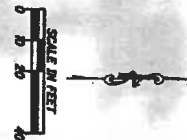
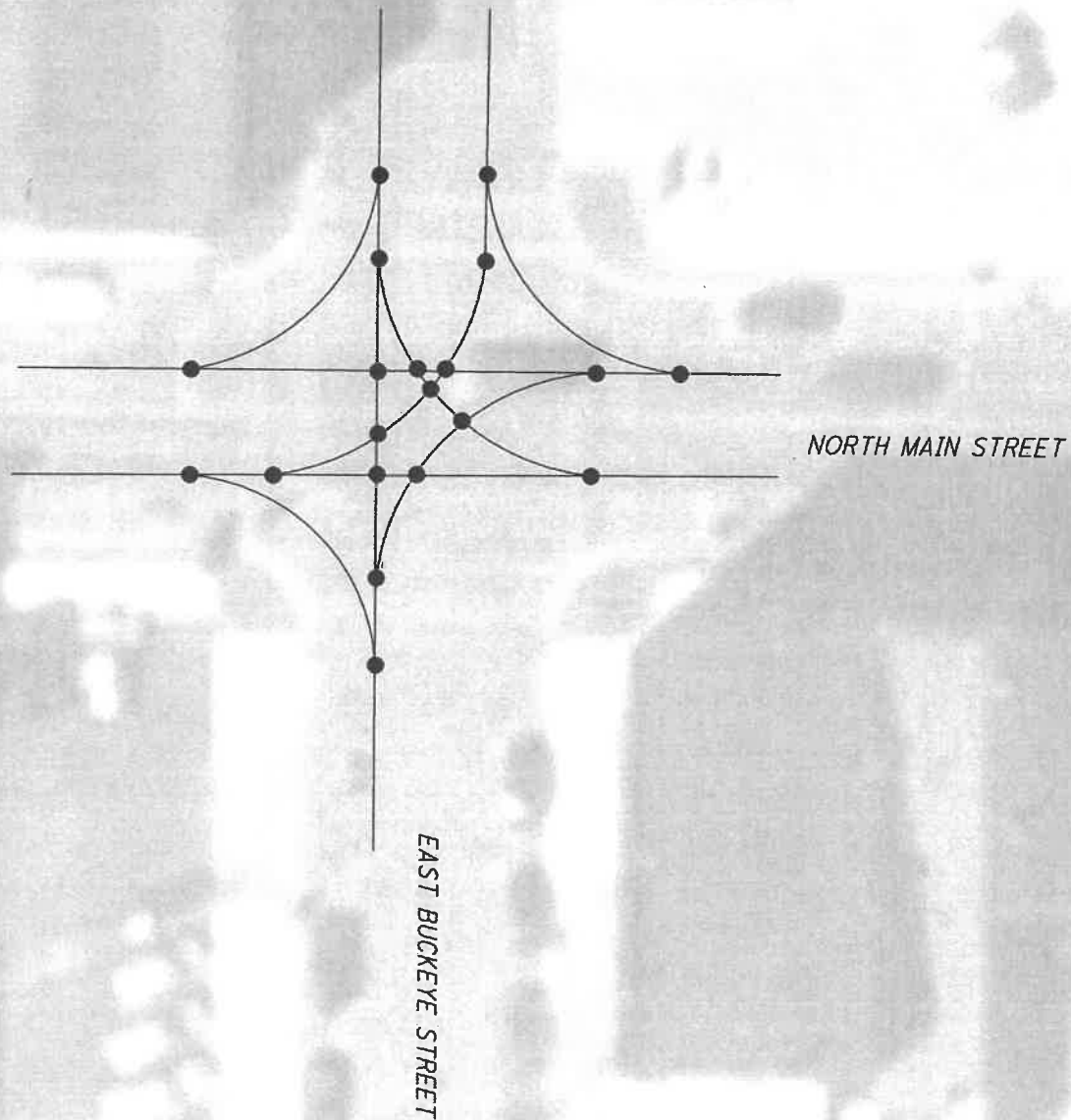

1 OF 1	SHEET NUMBER	05/20/2022	DATE PLOTTED	PROJECT No.	180802500	CHECKED BY	MAN	DRAWN BY	MAN	FILE NAME	EAST BUCKEYE STREET CONCEPT PLAN
--------	--------------	------------	--------------	-------------	-----------	------------	-----	----------	-----	-----------	----------------------------------

**EAST BUCKEYE STREET CONCEPT PLAN
VILLAGE OF ADA
CONFLICT POINTS - PROPOSED**

SEWEEY, OHIO 937.497.0200
LOVELAND, OHIO 513.239.8554
www.CHOICEONEENGINEERING.com



- "East Buckeye Concept site plan - SightDistance" - Shows that for west bound traffic on East Buckeye, the appropriate site distance for a vehicle to know if it is safe to enter the intersection is NOT currently provided. The first three parking spaces in front of El Campo block the safe view of a driver stopped at the intersection going westbound.

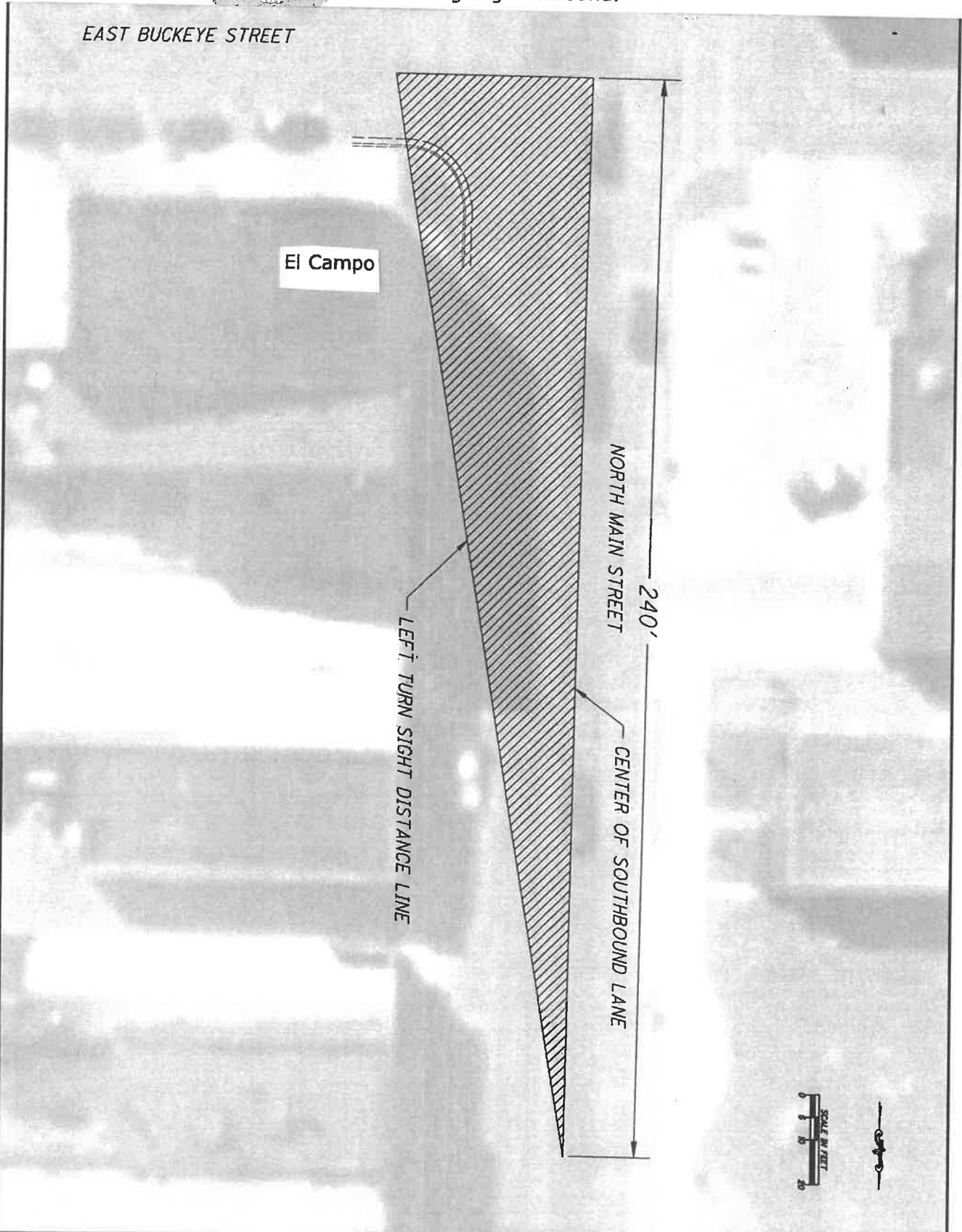

EAST BUCKEYE STREET CONCEPT PLAN VILLAGE OF ADA SIGHT DISTANCE		SIDNEY, OHIO 937.497.0200 LOVELAND, OHIO 513.329.8354 www.CHOICEONEENGINEERING.com	Choice One Engineering
REMARKS: _____ _____ _____	FILE NAME: EAST BUCKEYE STREET CONCEPT PLAN VILLAGE OF ADA SIGHT DISTANCE		
DRAWN BY: MNO	CHECKED BY: MNO		
DATE: 05/06/2022	PROJECT NO: M08001290		
SHEET NUMBER: 1 OF 1			

A one-way eastbound East Buckeye Street would also allow for an added benefit of more off-street parking than what currently exists in this block. Initial design layout shows an increase of 7 parking spaces.

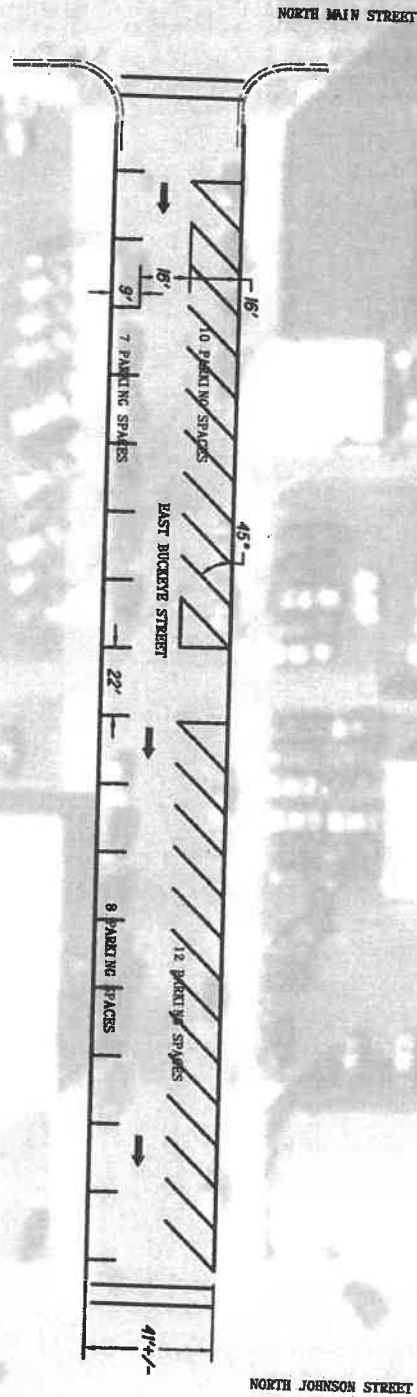

REVISIONS:
FILE NAME CONCEPT
DRAWN BY BYG
CHECKED BY MM
PROJECT NO. 1000000000
DATE 05/06/2022
SHEET NUMBER 1 OF 1

EAST BUCKEYE STREET CONCEPT PLAN
VILLAGE OF ADA
EAST BUCKEYE STREET CONCEPT PLAN

SHINEY, OHIO 937.497.0200
 LOVELAND, OHIO 513.229.8554
 WWW.CHOICEONEENGINEERING.COM

